









Adam Hayes - North Finchley Office - Lettings 365 Ballards Lane, North Finchley, London, N12 8LL

Tel: 020 8445 4008 Email: [info@adam-hayes.co.uk](mailto:info@adam-hayes.co.uk) Web: [www.adam-hayes.co.uk](http://www.adam-hayes.co.uk)

Ashbourne Close, Woodside Park, N12 8SA

£1,200 PCM

 0 Bedrooms  1 Bathrooms  1 Receptions

Key Features

- Studio Flat
- Close to Woodside Park Tube
- 16ft Living Area
- Balcony
- Communal Parking

Other Information

Council Tax Band: B  
Length of Tenancy: Long Let  
Deposit: £1,380

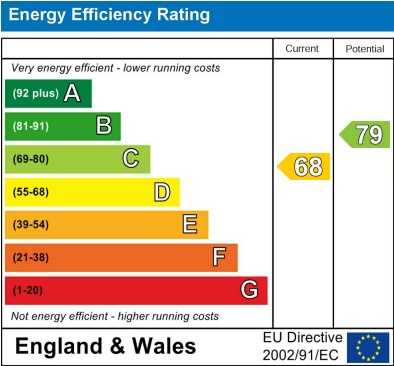

Nearest Stations

- Woodside Park

Property Description

A lovely second floor purpose built studio apartment situated within close proximity to Woodside Park Tube Station (Northern Line) and local amenities. The property benefits from an approximately 16ft living area, double glazing, a balcony, a three piece bathroom suite, ample storage and communal parking. North Finchley High Road which hosts an array cafes, restaurants and shopping facilities is also within easy access. To really appreciate the size and location, an internal viewing is highly recommended!

Adam Hayes - North Finchley Office - Lettings 365 Ballards Lane, North Finchley, London, N12 8LL

Tel: 020 8445 4008 Email: info@adam-hayes.co.uk Web: www.adam-hayes.co.uk

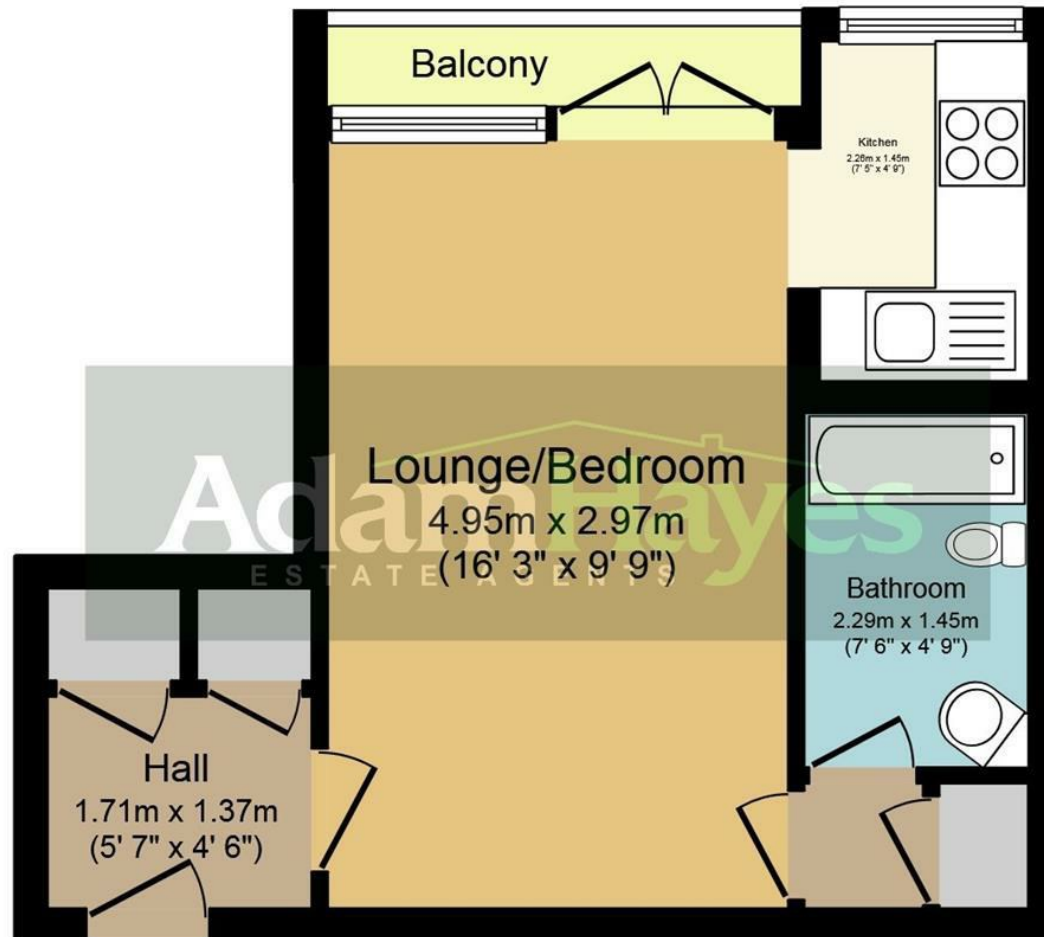

## Floor Plan

Total floor area 27.0 sq.m. (290 sq.ft.) approx

This plan is for illustration purposes only and may not be representative of the property. Plan not to scale.

These particulars, whilst believed to be accurate, are set out as a general outline only for guidance and do not constitute any part of an offer or contract. Intending purchasers or prospective tenants should not rely on them as statements or representation of fact, but must satisfy themselves by inspection or otherwise as to their accuracy. We have not carried out a detailed survey, not tested the services, appliances and specific fittings. Room sizes should not be relied upon for carpets and furnishings. The measurements given are approximate. No person in this firm's employment has the authority to make or give any representation or warranty in respect of the property.